

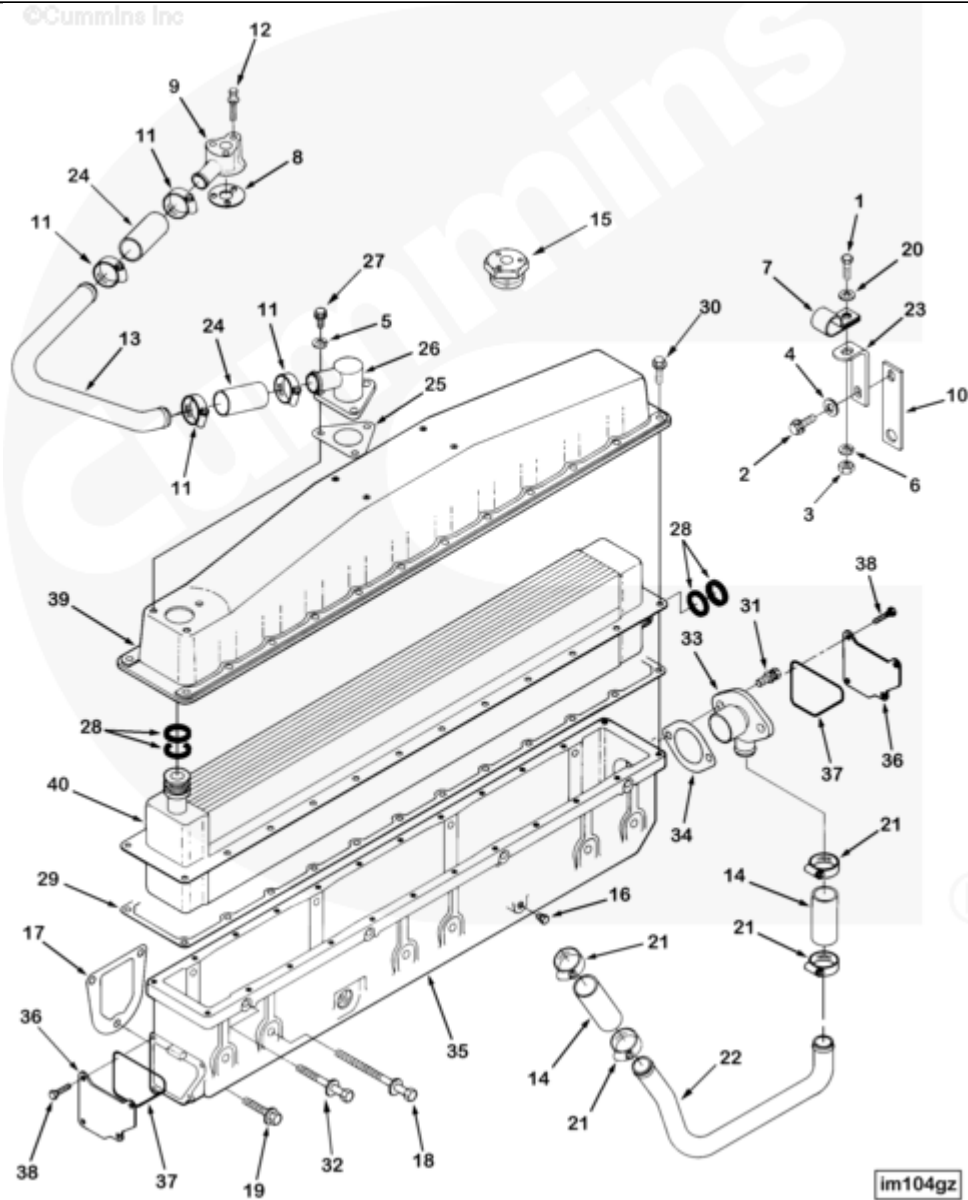

## Parts Catalog - Option Detail

| Electronic Parts Catalog - Option Detail |                                      |         |           |           |
|--|--------------------------------------|---------|-----------|-----------|
| Option                                   | Group                                | Graphic | Film Card | Date      |
| IM1131                                   | 10.01                                | im104gz | F         | 15-FEB-96 |
| <b>Engines</b>                           | NH/NT 855, NT495, NT743, NTA855 N106 |         |           |           |



[SMALL](#) | [MEDIUM](#) | [LARGE](#)

| Cart  | Ref No | Part Number | Part Description | Required | Remarks                              |
|---|--------|-------------|------------------|----------|--------------------------------------|
| <input type="button" value="View My Cart"/> |        |             |                  |          |                                      |
|   |        | IM1131      | Intake Manifold  |          | Die cast crossbolt type air...(More) |

|                          |    |         |                                  |   |                               |
|--------------------------|----|---------|----------------------------------|---|-------------------------------|
|                          |    |         |                                  |   | intake manifold with standard |
|                          |    |         |                                  |   | hose, standard front and rear |
|                          |    |         |                                  |   | water tubes.                  |
| <input type="checkbox"/> | 1  | S 112   | Hexagon Head Cap Screw           | 1 | 3/8 - 16 X 1 in.              |
| <input type="checkbox"/> | 2  | S 190   | Hexagon Head Cap Screw           | 1 | 5/8 - 18 x 1 inch             |
| <input type="checkbox"/> | 3  | S 223   | Heavy Hexagon Nut                | 2 | 3/8 - 16 UNC                  |
| <input type="checkbox"/> | 4  | S 602   | Plain Washer                     | 1 | 3/8 in.                       |
| <input type="checkbox"/> | 5  | S 603   | Lock Washer                      | 1 | 5/8 in.                       |
| <input type="checkbox"/> | 6  | S 604   | Lock Washer                      | 3 | 3/8 in.                       |
| <input type="checkbox"/> | 7  | 107460  | Clip                             | 2 |                               |
| <input type="checkbox"/> | 8  | 215045  | Water Transfer Connection Gasket | 1 |                               |
| <input type="checkbox"/> | 9  | 217932  | Water Outlet Connection          | 1 |                               |
| <input type="checkbox"/> | 10 | 217934  | Water Crossover Brace            | 1 |                               |
| <input type="checkbox"/> | 11 | 3010550 | Hose Clamp                       | 4 | 3/4 - 1 7/16 in.              |
| <input type="checkbox"/> | 12 | 3019572 | Captive Washer Cap Screw         | 3 |                               |
| <input type="checkbox"/> | 13 | 3036258 | Water Transfer Tube              | 1 |                               |
| <input type="checkbox"/> | 14 | 3056138 | Plain Hose                       | 2 |                               |
| <input type="checkbox"/> | 15 | 215587  | Plug Adapter                     | 1 |                               |
| <input type="checkbox"/> | 16 | 70295   | Pipe Plug                        | 1 |                               |
| <input type="checkbox"/> | 17 | 3008591 | Intake Manifold Gasket           | 3 |                               |
| <input type="checkbox"/> | 18 | 3028967 | Captive Washer Cap Screw         | 6 | 3/8 - 16 x 5 7/32 in.         |
| <input type="checkbox"/> | 19 | 3051427 | Captive Washer Cap Screw         | 3 | 3/8 - 16 X 1 5/16 in.         |
| <input type="checkbox"/> | 20 | 3000082 | Plain Washer                     | 1 | 15/32 in.                     |
| <input type="checkbox"/> | 21 | 3010550 | Hose Clamp                       | 4 | 3/4 - 1 7/16 in.              |
| <input type="checkbox"/> | 22 | 3018099 | Water Transfer Tube              | 1 |                               |
| <input type="checkbox"/> | 23 | 3035607 | Tube Brace                       | 1 |                               |
| <input type="checkbox"/> | 24 | 3820664 | Plain Hose                       | 2 |                               |
| <input type="checkbox"/> | 25 | 215044  | Water Transfer Connection Gasket | 1 |                               |
| <input type="checkbox"/> | 26 | 3013296 | Water Outlet Connection          | 1 |                               |
| <input type="checkbox"/> | 27 | 3015283 | Captive Washer Cap Screw         | 3 | 5/16 - 18 x 3/4 in.           |

|                          |    |                         |                                  |    |                       |
|--------------------------|----|-------------------------|----------------------------------|----|-----------------------|
| <input type="checkbox"/> | 28 | <a href="#">195952</a>  | O-Ring Seal                      | 4  |                       |
|                          | 29 | <a href="#">216486</a>  | Aftercooler Housing Gasket       | 1  |                       |
| <input type="checkbox"/> | 30 | <a href="#">3005508</a> | Hexagon Flange Head Cap Screw    | 24 | 5/16 - 18 x 7/8 in.   |
| <input type="checkbox"/> | 31 | <a href="#">3012471</a> | Captive Washer Cap Screw         | 2  | 3/8 - 16 x 1 1/8 in.  |
| <input type="checkbox"/> | 32 | <a href="#">3030286</a> | Captive Washer Cap Screw         | 8  | 5/16 - 18 x 1 1/2 in. |
| <input type="checkbox"/> | 33 | <a href="#">3030843</a> | Water Inlet Connection           | 1  |                       |
| <input type="checkbox"/> | 34 | <a href="#">3032348</a> | Water Transfer Connection Gasket | 1  |                       |
| <input type="checkbox"/> | 35 | <a href="#">3036811</a> | Air Intake Manifold              | 1  |                       |
| <input type="checkbox"/> | 36 | <a href="#">3029815</a> | Cover Plate                      | 2  |                       |
| <input type="checkbox"/> | 37 | <a href="#">3029816</a> | O-Ring Seal                      | 2  |                       |
| <input type="checkbox"/> | 38 | <a href="#">3077771</a> | Self Tapping Metal Screw         | 8  |                       |
| <input type="checkbox"/> | 39 | <a href="#">3046170</a> | Aftercooler Cover                | 1  |                       |
| <input type="checkbox"/> | 40 | <a href="#">3068724</a> | Aftercooler Core                 | 1  |                       |

© 2019 Cummins Inc., Box 3005, Columbus, IN 47202-3005 U.S.A.  
Terms of Use and Disclaimers | Recommended System Requirements  
Need Assistance? Please click on the Contact Us button in the top right corner of any page.